

Date: 12<sup>th</sup> Day of May 20

Clare County Council,  
Planning & Development Department,  
New Road,  
Cappahard,  
Ennis,  
County Clare.

**Re: Proposed application by Coillte Cuideachta Ghníomhaíochta Ainmnithe ("Coillte") for  
Planning Permission in respect of Wind Energy Project development at Carrownagowan,  
Slieve Bernagh, County Clare**

**Property comprised in Folios CE11462 and CE26558**

**Letter of Consent to Application for Planning Permission**

Dear Sirs,

I confirm that I am the registered owner of all of the property comprised in Folios CE11462 and CE26558 (the "Property").

I refer to the proposed development of a wind farm by at Carrownagowan, Slieve Bernagh, County Clare (the "Development"), the proposed layout of which is identified on the draft map attached hereto.

I understand that Coillte intends to make an application for planning permission in respect of the Development and I hereby consent to the inclusion of the Property in all planning applications relating to the Development that may be submitted by Coillte or any associated company.

Should you have any queries in relation to the above, please do not hesitate to contact me.

Yours faithfully,

  
Phillip Hogan



Rev.	Date	Description	by	ch'd	app
A	06.11.19	Issued For Information	JK	HBR	HBR

Client  
Carrowmagowan Wind Farm

Title  
Land Purchase Required at Philip Hogan's Land  
Folios CE11462 and CE26558

Checked HBR  
Drawn JK  
Drg. No. 19107-0052  
06.11.2019

Scales (A3)  
1:2,500

Malachy Walsh and Partners  
Consulting Engineers  
Cork | Tralee | London | Limerick

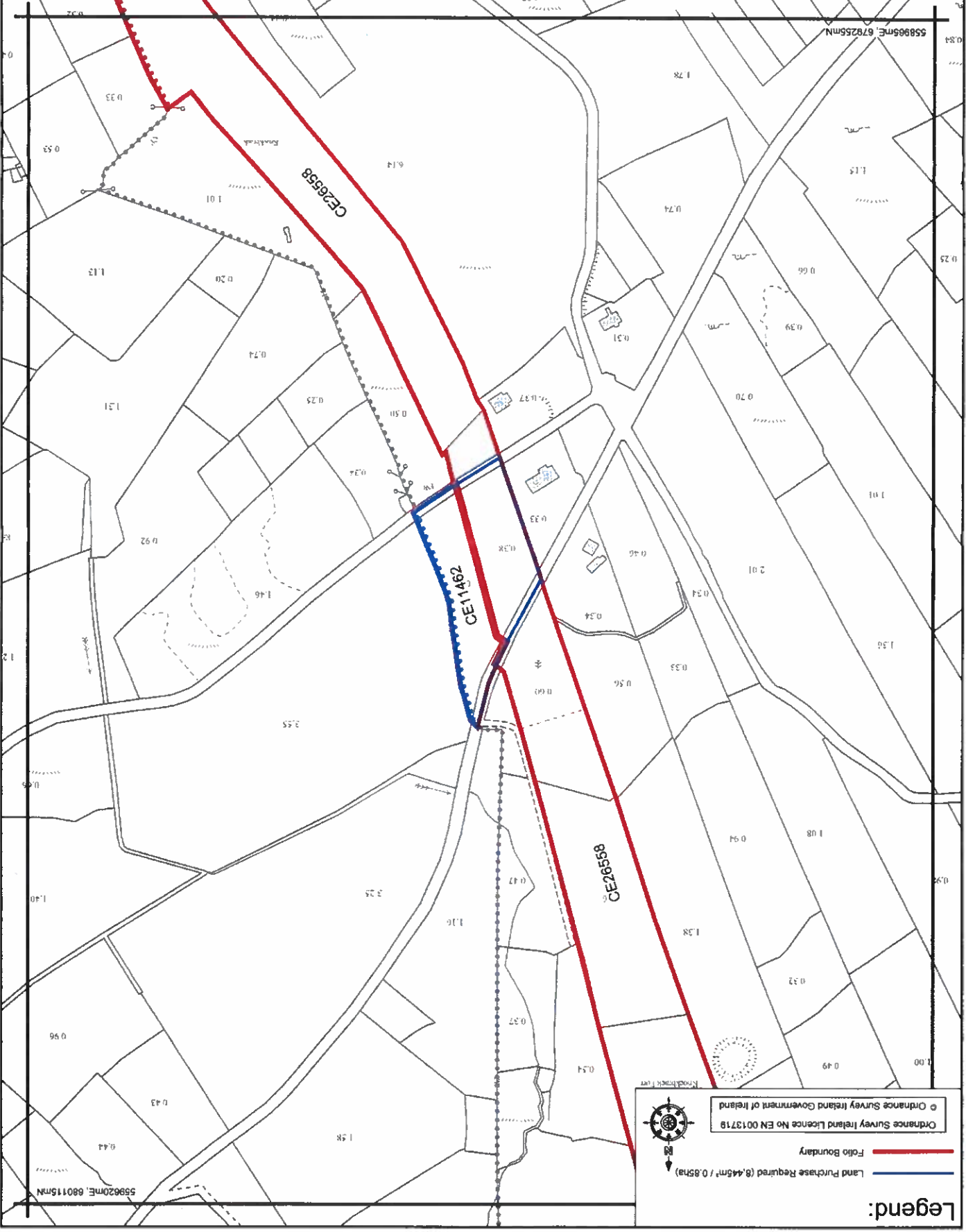

Legend:  
 — Folio Boundary  
 — Land Purchase Required (8.465m² / 0.85ha)

Ordnance Survey Ireland Licence No EN 0013719  
 © Ordnance Survey Ireland Government of Ireland